



World Guide Rail Alliance



s p e c i f i c a t i o n s



## Standard Machined Guide Rails

### USA/Canada

Monteferro America  
Phone (204) 222-0247  
1-866-222-0247  
Fax (204) 224-4275  
E-mail: [sales@monteferroamerica.com](mailto:sales@monteferroamerica.com)

### Italy

Monteferro S.p.A.  
Phone: ++39-0332-970970  
Fax: ++39-0332-971016  
E-mail: [customer.service@monteferro.i](mailto:customer.service@monteferro.i)

### Brazil

Monteferro América Latina L.T.D.A.  
Phone: ++55-11-38744760  
Fax: ++55-11-38744764  
E-mail: [mfalvend@aol.com](mailto:mfalvend@aol.com)

### Czech Republic

Monteferro Hradek A.S.  
Phone: ++420-181-725467  
Fax: ++420-181-725477  
E-mail: [customer.service@monteferro.cz](mailto:customer.service@monteferro.cz)

### China

Hebei Monteferro Guide Rails Co., L.T.D.  
Phone: ++86-317-2029504  
Fax: ++86-317-2026327  
E-mail: [montefer@public.czptt.he.cn](mailto:montefer@public.czptt.he.cn)

### Hong Kong

Monteferro Pacific Trading Ltd.  
Phone: ++852-25214225  
Fax: ++852-25261393  
E-mail: [mfpt@hkstar.com](mailto:mfpt@hkstar.com)

Printed in Canada

ISO 9002 certified since 1995

Monteferro America

# Standard Machined Guide Rails



Monteferro's **Standard** guide rails are manufactured in standard lengths of 7', 8', 9' and 16'. T70 and T89 rails are also available in 10' lengths. Metric lengths of 5m and 2.5m as well as custom machined and saw cut lengths are also available.

## Dimensions

All dimensions in inches unless noted.

Monteferro Code	ISO Code	q <sub>1</sub> lb/ft	b <sub>1</sub>	h <sub>1</sub>	h	k	n	c	g	f	m <sub>1</sub>	m <sub>2</sub>	t <sub>1</sub>	t <sub>2</sub>	d	d <sub>1</sub>	l	b <sub>3</sub>	l <sub>2</sub>	l <sub>3</sub>	
<b>Tolerances</b>				+/- 0.06	+/- 0.03	+/- 0.004	+0.004, -0				+0.0025, -0	+0, -0.0025	+/- 0.004	+/- 0.004					+/- 0.008	+/- 0.008	+/- 0.008
T70/B	—	6.25	2.75	1.978	1.937	0.625	1	0.375	0.313	0.4375	0.252	0.251	0.281	0.25	0.5625	N/A	6.14	1.813	4.50	1.50	
T89/B	T89/B	8.27	3.50	2.44	2.402	0.625	1.3125	0.375	0.313	0.4375	0.252	0.251	0.281	0.25	0.5625	1.024	6.14	2.250	4.50	1.50	
T114/B	—	11.12	4.50	3.50	3.465	0.625	1.5	0.375	0.313	0.4375	0.252	0.251	0.281	0.25	0.6875	1.299	6.14	2.625	4.50	1.50	
T127-1/B	T127-1/B	11.94	5.00	3.50	3.465	0.625	1.75	0.375	0.313	0.4375	0.252	0.251	0.281	0.25	0.6875	1.299	6.14	3.125	4.50	1.50	
T127-2/B	T127-2/B	15.11	5.00	3.50	3.465	0.625	2	0.375	0.500	0.625	0.252	0.251	0.281	0.25	0.6875	1.299	6.14	3.125	4.50	1.50	
T140-1/B	T140-1/B	18.55	5.50	4.25	4.213	0.748	2	0.5	0.500	0.625	0.252	0.251	0.281	0.25	0.8125	1.575	7.6	3.625	6.00	1.25	
T140-2/B	T140-2/B	22.79	5.50	4.02	3.976	1.125	2	0.6875	0.563	0.6875	0.252	0.251	0.281	0.25	0.8125	1.575	7.6	3.625	6.00	1.25	
T140-3/B	T140-3/B	30.91	5.50	5.00	4.961	1.250	2.25	0.75	0.688	1.000	0.252	0.251	0.281	0.25	0.8125	1.575	7.6	3.625	6.00	1.25	

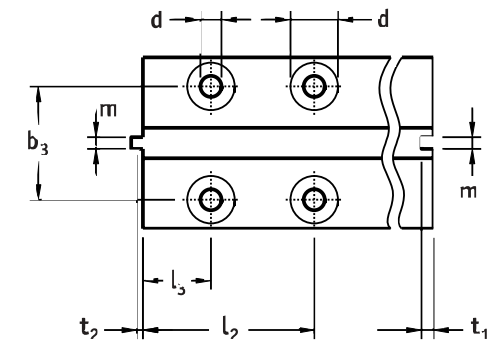
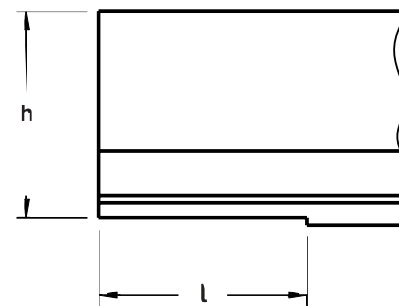
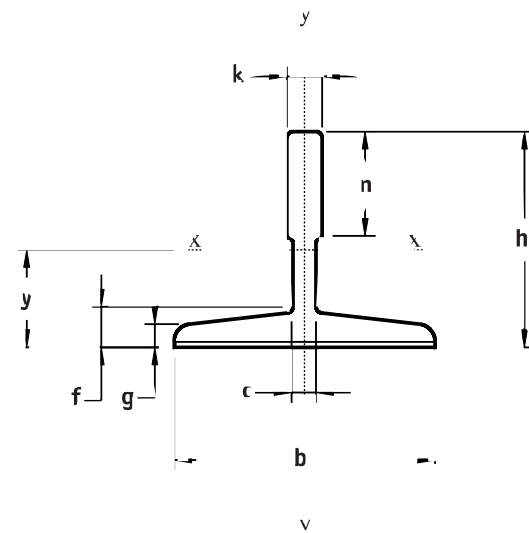

## Tolerances

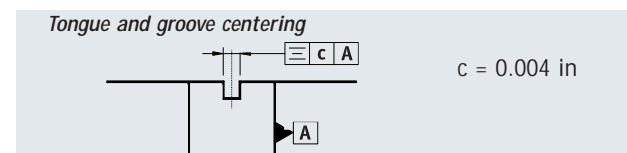
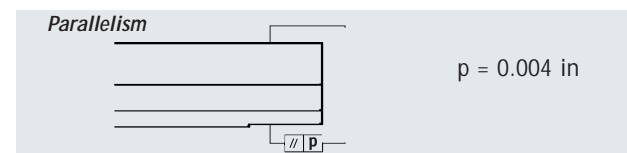
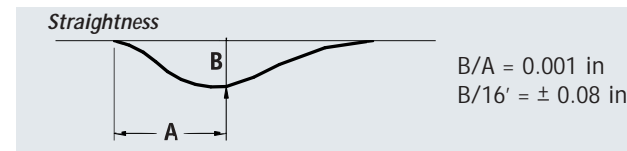
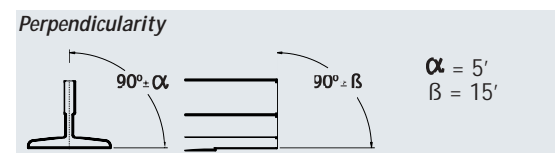
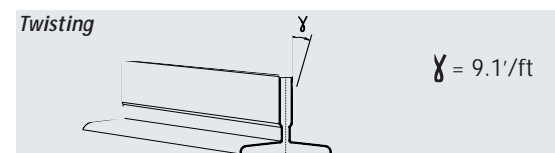
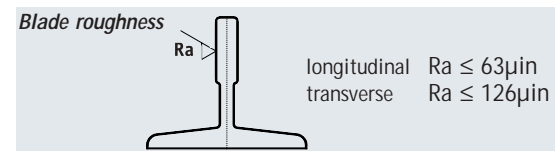

## Sectional properties

Monteferro Code	ISO Code	A in <sup>2</sup>	q <sub>1</sub> lb/ft	Y in	I <sub>xx</sub> in <sup>4</sup>	Z <sub>x</sub> in <sup>3</sup>	r <sub>x</sub> in	I <sub>yy</sub> in <sup>4</sup>	Z <sub>y</sub> in <sup>3</sup>	r <sub>y</sub> in
T70/B	—	1.79	6.25	0.67	0.66	0.52	0.60	0.62	0.46	0.59
T89/B	T89/B	2.43	8.27	0.80	1.43	0.87	0.77	1.26	0.72	0.72
T114/B	—	3.22	11.12	1.13	4.30	1.81	1.16	2.59	1.17	0.90
T127-1/B	T127-1/B	3.51	11.94	1.08	4.47	1.86	1.13	3.56	1.43	1.01
T127-2/B	T127-2/B	4.44	15.11	0.97	4.77	1.89	1.04	5.53	2.21	1.11
T140-1/B	T140-1/B	5.46	18.55	1.28	9.71	3.26	1.33	7.45	2.70	1.17
T140-2/B	T140-2/B	6.70	22.79	1.37	10.98	4.15	1.28	8.60	3.12	1.13
T140-3/B	T140-3/B	9.08	30.91	1.72	22.90	6.99	1.59	11.68	4.24	1.13